

Scan the QR code to download mobile app

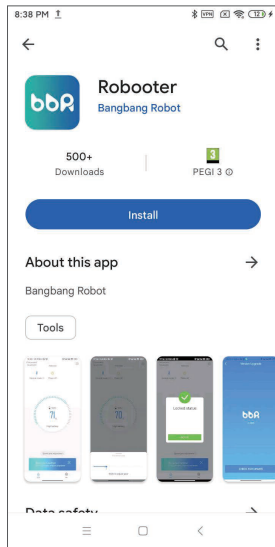

Install mobile app

Connect Device



The above screen is displayed after scanning, click **Install** to install the mobile app.

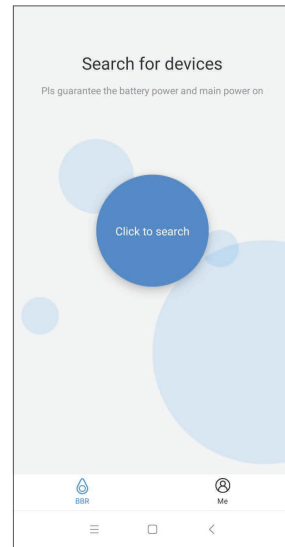

Click **Click to search** on the above screen to search device.

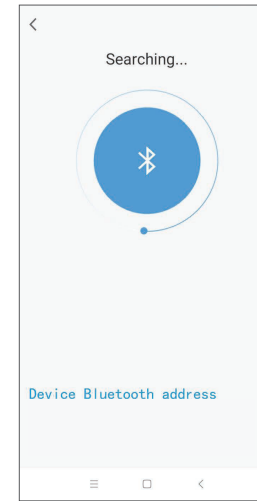

Once the above operation has been completed, the mobile app starts searching for the device. Click **DF:85:EC:73:15:05** to pair the mobile app with the device.

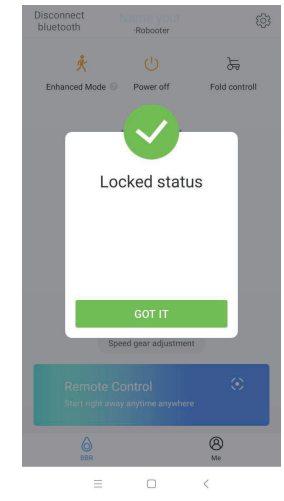

The above screen indicates a successful connection. Click **GOT IT** in the above screen to access status screen of the electric wheelchair

Note:
When the electric wheelchair is in lock mode, display this interface. After turning on the electric wheelchair, enter the lock mode automatically. Only use the mobile app after unlocking on the electric wheelchair.

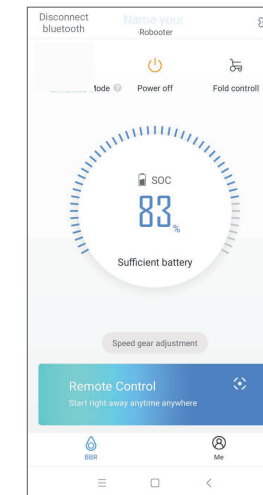

Click **Power off** to turn off the device.

Click **Disconnect bluetooth** to disconnect the bluetooth connection.

Click **Speed gear adjustment** to adjust the device speed. (Adjustable speed in 5 gears)

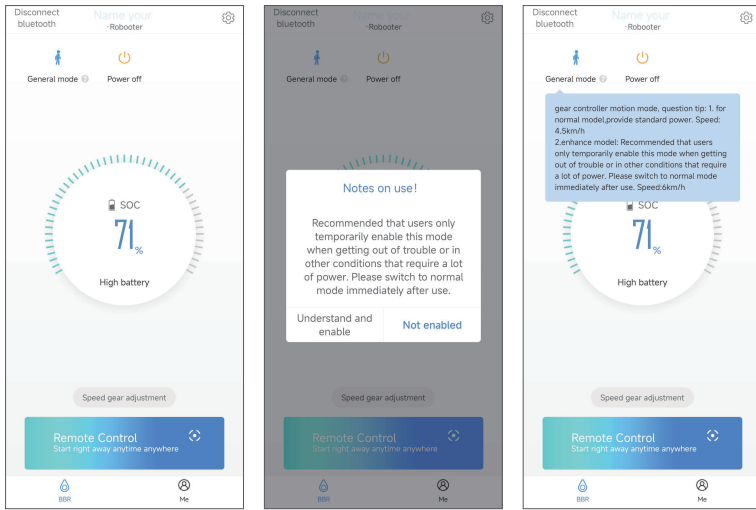

Click  in status screen to access enhanced mode adjustment and general mode adjustment.

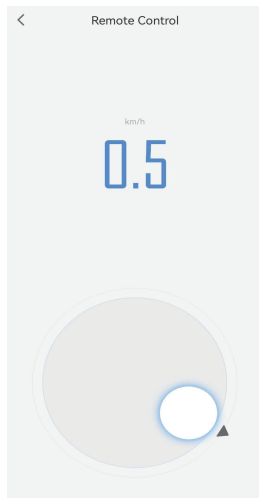

Click **Remote Control** in the status screen to access the remote control mode. Circle up to move forward, down to move back, left to turn left, right to turn right.

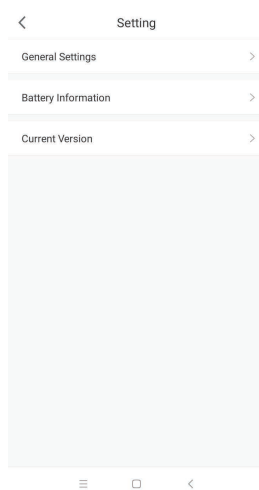

Click  in the top right corner to access the setting screen.

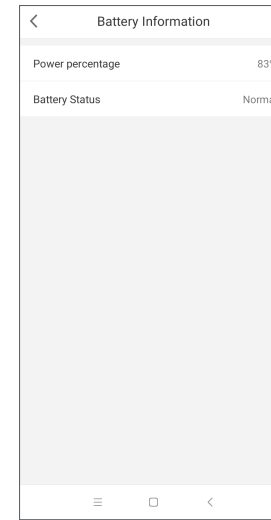

Click "Battery information" in the setting screen to access battery information screen. Shows battery power percentage and battery status.

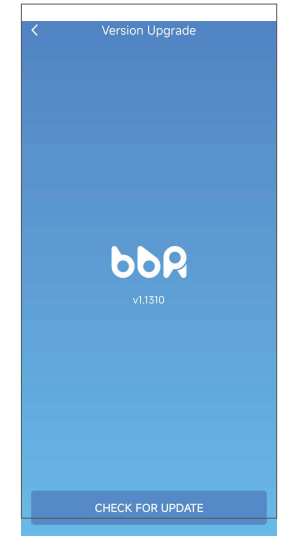

Click "Current Version" in the setting screen to access version. Show current device version. Click **CHECK FOR UPDATE** to upgrade version of device.

Minimum System Requirements

- Android version 6.0 or higher
- iOS version 9.0 or higher
- Bluetooth version 4.0 or higher
- Minimum RAM: 1 GB
- Required storage space: 50 MB